

As suppliers of building and civil engineering products Parchem Construction Supplies Pty Ltd do not offer a design service. Information in this drawing is a suggestion only and must not be used for construction except as a signed off drawing by the specifier or contractor

This drawing is the copyright of Fosroc Ltd. (modified by permission) and must not be reproduced in any part without prior written permission

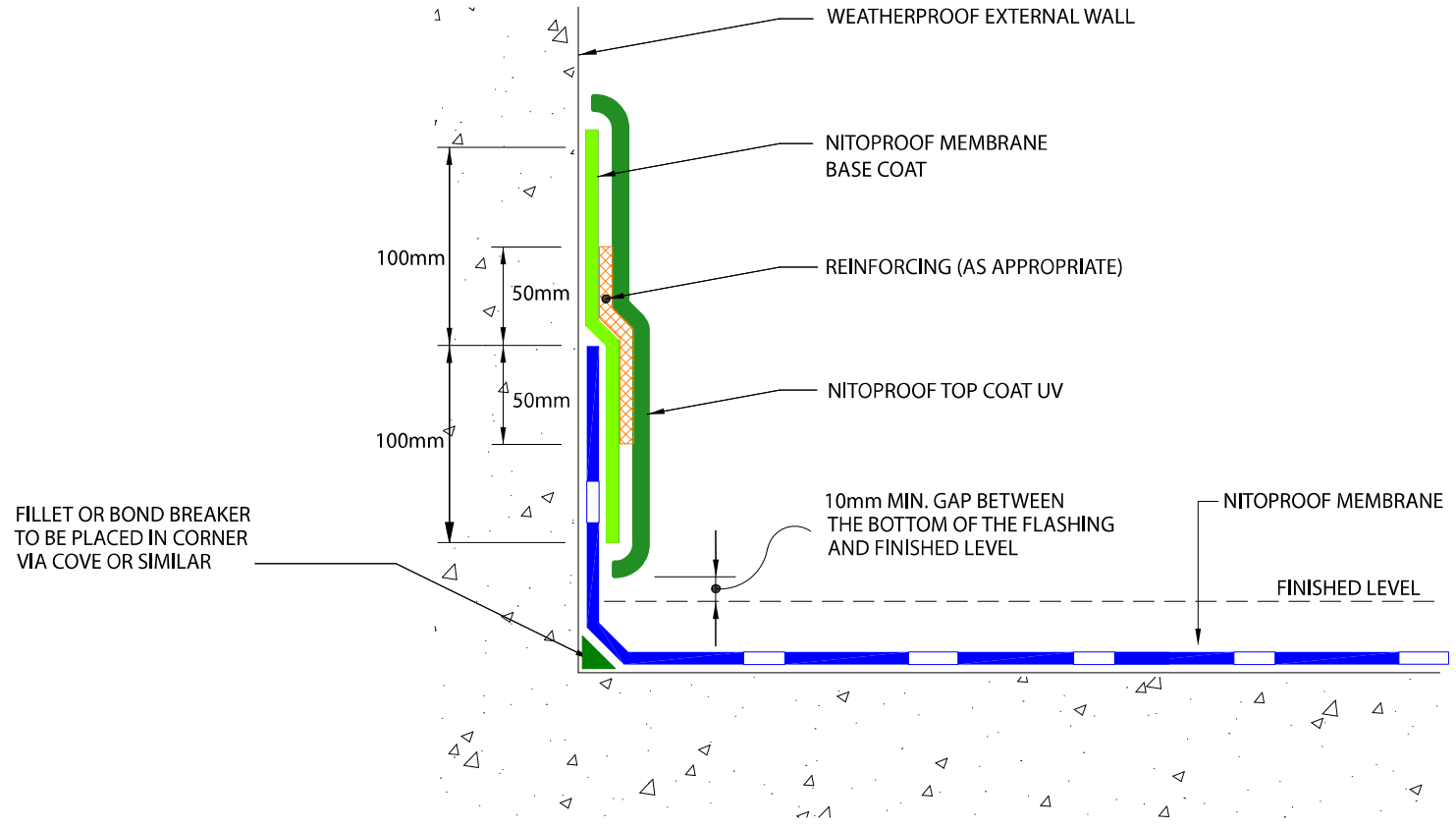

(b) OVERFLASHING CONSTRUCTED OF A LIQUID-APPLIED MEMBRANE

VERTICAL UPWARD TERMINATION - DETAIL OF OVERFLASHING (d)
(OVERFLASHING CONSTRUCTED OF A LIQUID-APPLIED MEMBRANE)

SCALE:- NTS
 DRAWN BY:- EC
 DATE:- 8/7/10
 LATEST AMENDMENT:- PJ
 DATE:- 26/08/19

TSD/W-ISD22	ISSUE NUMBER 2
	
PARCHEM CONSTRUCTION SUPPLIES 7 LUCCA ROAD, WYONG NSW 2259 www.fosroc.com.au 1800 812 864	
<small>Fosroc and the Fosroc logo, are the trade marks of Fosroc International Limited, used under licence</small>	