

As suppliers of building and civil engineering products Parchem Construction Supplies Pty Ltd do not offer a design service. Information in this drawing is a suggestion only and must not be used for construction except as a signed off drawing by the specifier or contractor

C This drawing is the copyright of Parchem Construction Supplies and must not be reproduced in any part without prior written permission

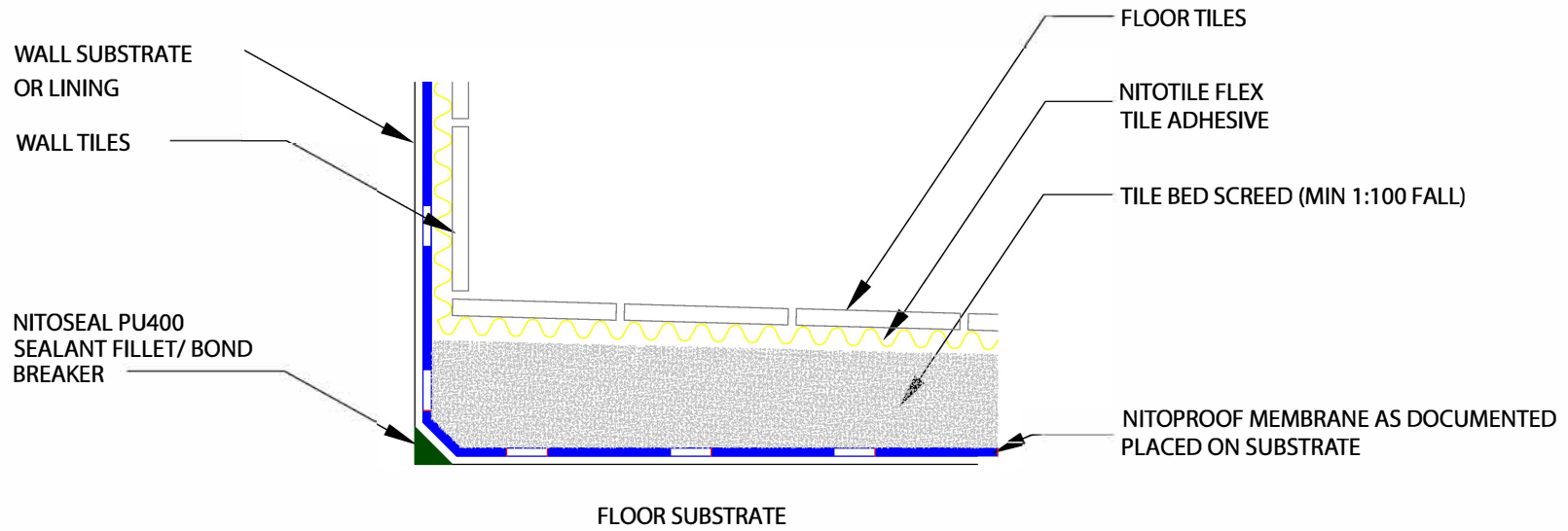

NOTE: WATERPROOF MEMBRANES SHOULD BE TERMINATED AT A MINIMUM HEIGHT OF 150mm ABOVE FINISHED FLOOR LEVEL (EXCEPT IN SHOWER AREAS). WATERPROOF ENTIRE FLOOR AREA.

**TYPICAL UNDER-TILE WATERPROOFING/TILE ADHESIVE SYSTEM
(MEMBRANE UNDER SCREED) - MEETS AS3740**

SCALE:- NTS

DRAWN BY:- MN
DATE:- 16-7-13

LATEST AMENDMENT:- PJ
DATE:- 30/10/19

TSD/W-WASD07

ISSUE NUMBER 2



PARCHEM CONSTRUCTION SUPPLIES
7 LUCCA ROAD, WYONG
NSW 2259

www.fosroc.com.au
1800 812 864

Fosroc and the Fosroc logo, are the trade marks of Fosroc International Limited, used under licence