



constructive solutions

POLYURETHANE JOINT SEALANT

NITOSEAL® PU250

Replaces Emer-Seal PU25

Nitoseal PU250 is a high performance construction sealant for vertical exterior and interior applications.



USES

- Sealing joints in concrete panels, cement products, blockwork, and brickwork
- Sealing joints in window frames and between metal
- In concrete floors and pavements.

FEATURES

- Weather resistant
- Excellent primerless adhesion to most substrates
- Flexible, one-component, elastomeric polyurethane sealant technology
- Low odour
- Available in Concrete Grey, White & Black

IMPROVED FORMULA COMPARED TO EMER-SEAL PU25

- Low stringing
- Easy to gun out

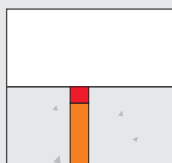

Joint Fillers & Sealants

For further information about our sealants range visit fosroc.com.au or fosroc.co.nz

Always refer to the product TDS before making your final selection or speak to your Fosroc representative.

Nitoseal® PU250

Replaces Emer-Seal PU25

Uses

- Sealing joints in concrete panels, fibrous cement products, external cladding panels, blockwork and brickwork
- Also excellent in sealing joints around aluminium and timber door and window frames and between metal
- Ideal for wide floor joints 5mm to 35mm

High performance formula

Nitoseal PU250 has the same high performance as Emer-Seal PU25 with improvements including;

- Easier to gun with improved consistency compared to Emer-Seal PU25
- Up to 65% less stringing during tooling compared to Emer-Seal PU25

Description

Nitoseal PU250 is a high performance elastomeric joint sealant based on polyurethane technology. Nitoseal PU250 uses a cure system reacting on exposure to atmospheric moisture. When cured it forms a waterproof and durable seal, acting as a barrier to rain, wind and dust, which makes it ideal for exterior applications.

Design Criteria

Nitoseal PU250 may be applied in joints between 15mm and 35mm wide.

Properties

Data quoted are typical for this product but do not constitute a specification.

Form:	Smooth, non-slump paste
Movement accommodation factor:	± 25% (total 50%)
Tack free time:	90 mins (+/- 10mins) at 23°C, 50% RH
Cure speed:	3mm / day 23°C 50% RH
Typical hardness Shore 'A' (ISO 868):	25 (+/-5)
100% Modulus (ISO 8339):	0.20 - 0.30 MPa
Elongation at break:	>500%
Continuous service temperature range:	- 40°C to + 70°C

Supply

Product Code	Description	Size
FC920112-600ml	Nitoseal PU250 Concrete Grey	600ml
FC920127-600ml	Nitoseal PU250 White	600ml
FC920128-600ml	Nitoseal PU250 Black	600ml

Coverage Guide

600ml sausage will supply 3 metres of 20mm x 10mm sealant bead.

Please refer to our Nitoseal PU250 Technical Data Sheet for further information on this product.

AU 1800 812 864
fosroc.com.au

NZ 0800 657 156
fosroc.co.nz

Parchem Construction Supplies Pty Ltd
1956 Dandenong Rd, Clayton VIC AUS 3168

Distributed in New Zealand by Concrete Plus Ltd
150 Hutt Park Road, Gracefield NZ 5010

Fosroc, the Fosroc logo and Nitoseal are trade marks of Fosroc International Limited, used under licence.