

FOSROC

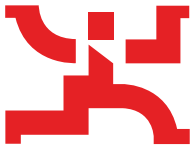

*constructive solutions*

# **WATER & WASTE WATER INDUSTRY SOLUTIONS**







## About Fosroc and Parchem

Fosroc is a world leader in construction solutions. Since the company's beginnings over 80 years ago, Fosroc has developed into an international leader in delivering construction solutions for virtually any building or infrastructure project. New or old construction above or below ground, we combine high quality products, expert technical support, customer service and innovation to give you the best solution for your project.

We provide construction solutions for; new and old concrete repair, grouts, waterproofing, joint fillers & sealants, industrial flooring, protective coatings, surface treatments, and concrete additives.

Fosroc has an extensive network of offices and manufacturing locations across Europe, the Middle East, India and Asia, and is further represented in other regions across the world by distributor and licensee partners.

Parchem Construction Supplies, part of DuluxGroup, is the licensed manufacturer and distributor of Fosroc, Vector®, Vandex®, and EdenCrete® products in Australia, and Concrete Plus™ is the licensed distributor in New Zealand.

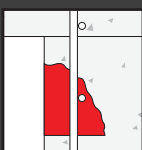

Concrete Repair

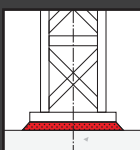

Grouts

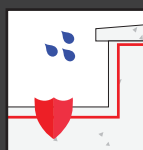

Waterproofing

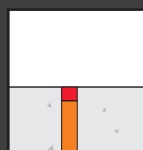

Joint Fillers & Sealants

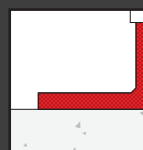

Industrial Flooring

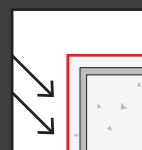

Protective Coatings



Surface Treatments



Concrete Additives



# Water & Waste Water Industry Solutions



✓ Drains & culverts



✓ Dams & reservoirs



✓ Desalination plants



✓ Irrigation channels & canals



✓ Tanks



✓ Swimming pools



✓ Water towers



✓ Water treatment plants

# Our Range

Fosroc offers a comprehensive range of world class products to meet the needs of the water and waste water industries for both new construction and refurbishment projects.

Our products can help give strong support to pumps and equipment, fix leaks in structures to avoid long term failures,

repair and protect surfaces to reduce deterioration caused by chemical attack, abrasion and climatic conditions.

Solutions can be tailored to projects of any size and scale with our wide range of waterproofing systems, joint fillers & sealants, protective coatings and concrete repair products.

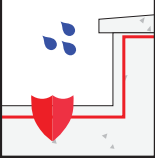
	Product	Type	Description	General Advantages	Typical applications
 <p><b>Waterproofing</b></p>	<b>Supercast PVC Waterstops</b>	Extruded PVC waterstops	PVC waterstops designed to provide an integral sealing system for movement and construction joints in poured in-situ concrete. The range consists of centrally placed Hydrofoil profiles, externally placed Rearguard S and Rearguard R profiles.	Potable Water approved - complies to AS/NZS4020.	Tanks, reservoirs, water towers, sewage tanks, dams, culverts, canals and spillways, swimming pools.
	<b>Hydrotite</b>	Hydrophilic waterstops	Hydrophilic waterstop which expands in a controlled manner in the presence of moisture to create a pressure seal within construction joints in cast in-situ concrete structures.	Self adhesive, no site welding required.	Sewerage treatment plants, reservoirs, water treatment plants & swimming pools.
	<b>Leakmaster</b>	Water swelling sealant	Gun applied, water-swellaable, moisture cure polyurethane waterstop paste for bonding Hydrotite profiles to rough concrete surfaces. It can also be used for sealing joints where conventional solid waterstops cannot be applied easily.	Bonds to rough surfaces.	Civil engineering, construction and water services.
	<b>Proofex Torchseal</b>	Torch applied waterproofing membranes	A range of APP (atactic polypropylene) based torch applied waterproofing membranes, ideal for the Australian and New Zealand climate.	Can be fully immersed.	Large horizontal areas such as reservoir roofs & internal lining of water tanks.
	<b>Vandex Range</b>	Cementitious waterproofing	Based in Switzerland, Vandex is the originator of "crystal growth" waterproofing. These products are cement based and provide the best solution to waterproofing on the negative pressure side of structures.	Flexible options for movement and cracks.	Potable water and water retaining structures, open sewage environments.
	<b>Proofex Engage</b>	Pre-applied waterproofing system	A unique patented waterproofing membrane system comprising a cell mesh bonded to a blended polyethylene/polypropylene membrane which allows poured concrete to interlock, forming a tenacious mechanical bond.	Mechanically bonds to poured concrete.	Below ground waterproofing.
	<b>Polyurea WPE110</b>	Pure polyurea waterproofing membrane	Spray-applied, 100% solids, flexible, two-component, rapid curing pure polyurea system. Designed as a waterproofing and protective coating.	Potable Water approved - complies to AS/NZS4020.	Potable water applications such as reservoirs, desalination plants, primary and secondary containment, clarifiers, aeration tanks.

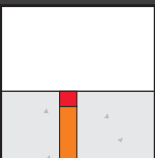
	Product	Type	Description	General Advantages	Typical applications
 <p><b>Joint Fillers &amp; Sealants</b></p>	<b>Hydrocor Corkjoint™</b>	Expanding cork joint filler	Self expanding cork fillers used for forming, filling and sealing expansion and static joints.	Self expanding.	Water retaining structures.
	<b>Hydrocell</b> (replaces Stiffjoint)	Joint Filler	Semi-rigid, UV resistant, cross-linked, non-absorbent, closed-cell polyethylene sheet material used to support joint sealants in expansion joints.	Long term performance in immersed applications.	Used in conjunction with suitable joint sealants in raw and potable water reservoirs, sewage treatment works, irrigation channels & culverts.
	<b>Nitoseal PU400</b> (replaces Emer-Seal PU40)	Joint Sealant	One part, polyurethane sealant with excellent resistance to biodegradation and superior abrasion resistance. Suitable for use in potable water environments, water immersed applications and trafficable surfaces.	Potable Water approved -complies to AS/NZS4020.	Sewage and storm water applications, potable water structures.
	<b>Nitoseal SC600</b> (replaces Emer-Seal CR)	Joint Sealant	One part, gun applied, non sag, joint sealant designed for sealing expansion and construction joints exposed to aggressive chemical environments.	Potable Water approved - complies to AS/NZS4020.	Biological environments in water and wastewater applications.
	<b>Expoband F</b> (replaces Emer-Band)	Joint bandage membrane	A highly flexible, chemically resistant, polyolefin joint bandage membrane system designed to be bonded (using Nitomortar AP) over movement joints or cracks in a structure to prevent the ingress of water and chemicals. The flexibility of the polyolefin allows the system to move yet remain tough enough to resist abrasion.	Can be fully immersed. Potable Water approved – complies to AS/NZS4020.	Tanks, sewers, reservoirs, pipelines and swimming pools.

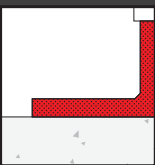

	Product	Type	Description	General Advantages	Use on	Finish
 <b>Industrial Flooring</b>	<b>Cemtop HD30 (replaces Aegis MSP)</b>	Floor topping	Durable polymer modified mortar, designed to re-surface rain damaged concrete. Available in fine grade for squeegee application; coarse grade for trowel application & heavy duty remedial work. Achieves P5 slip resistance rating.	Produces a cementitious, waterproof surface.	Internal & external floors.	Mid Grey, matt.
	<b>Nitoflor FC150 HP &amp; FC150 HP FC</b>	High build coating	Heavy duty, solvent free, low VOC, epoxy coating. Highly resistant to industrial chemicals and forklift/commercial type traffic. Achieves P5 slip resistance rating with added anti-slip grains.	Odourless & 'non-taint' when fully cured.	Internal floors.	Range of colours, semi-gloss.
	<b>Nitoflor N</b>	High build coating	Two part solvent free novolac epoxy floor coating for areas where aggressive chemical spills occur and high wear resistance is required. Add Nitomortar F4 fillers for a 5mm trowel finish. Achieves P5 slip resistance rating with added anti-slip grains.	Resistant to highly aggressive chemicals.	Internal floors.	Clear, semi-gloss.
	<b>Nitoflor PU200</b>	High build coating	Low odour, low VOC cementitious polyurethane floor sealer with anti-microbial properties. Produces a hardwearing, chemically resistant floor that can handle extreme temperatures. Achieves P5 slip resistance rating with added anti-slip grains.	Rapid cure, handles extreme temperatures, 'non-taint' when fully cured.	Internal floors.	Range of colours, matt.

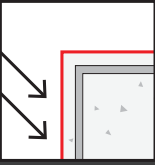
	Product	Type	Description	General Advantages	Typical applications
 <b>Protective Coatings</b>	<b>Nitocote EP405</b>	High build coating	Two part, solvent free, epoxy resin coating for potable water retaining structures. Produces a smooth, hygienic and tough finish. Available in blue and white.	Potable Water approved - complies to AS/NZS4020.	Tanks, reservoirs, water towers, water treatment works.
	<b>Nitocote EP410</b>	High build coating	Highly chemical resistant, high build, solvent free, two part epoxy coating. Provides protection to concrete in aggressive chemical exposure or immersion conditions. Available in white and grey.	Highly chemical and abrasion resistant.	Process plants and sewage works.
	<b>Nitocote EP500</b>	High build lining	Solvent free, two part, low odour, non-sag high build epoxy liner system. Typically spray-applied then trowel finished to produce a chemical and abrasion resistant liner, 2mm to 5mm thickness.	Resistant to biological attack.	Relining and rehabilitation of trunk line sewers, wet wells and manholes.
	<b>Dekguard Elastic</b>	High build coating	Crack accommodating elastomeric, pigmented, acrylic protective coating. Produces an excellent barrier to carbon dioxide, chloride ions, oxygen and water, particularly where there are cracks within the substrate. Available in a range of colours.	UV resistant.	External wall application of water retaining structures such as tanks.

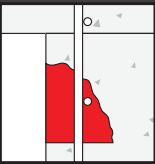
	Product	Type	Description	General Advantages	Typical applications
 <b>Concrete Repair</b>	<b>Renderoc HB40</b>	High build patch repair mortar	High build repair mortar for localised repair of reinforced concrete up to 35MPa. It can be applied to vertical concrete patches 10mm to 40mm deep. Suitable for use with embedded galvanic anodes.	Meets requirements of EN1504-3 Class R3. Potable Water approved - complies to AS/NZS4020.	Vertical and overhead concrete repairs.
	<b>Renderoc HB70</b>	High build patch repair mortar	High build repair mortar for localised repair of reinforced concrete >45MPa. It can be applied to vertical concrete patches 10mm to 40mm deep. Suitable for use with embedded galvanic anodes.	Meets requirements of EN1504-3 Class R4. Potable Water approved - complies to AS/NZS4020.	Vertical and overhead concrete repairs.
	<b>Renderoc LA55</b>	Deep section repair mortar	High build, free flowing micro-concrete repair mortar for thick section repairs where form and pour method is preferred, 30 to 60 MPa. Can be applied from 50mm to 200mm deep. Suitable for use with embedded galvanic anodes.	Meets requirements of EN1504-3 Class R4. Potable Water approved - complies to AS/NZS4020.	Vertical, horizontal and overhead concrete repairs.
	<b>Nitomortar AP</b>	Adhesive repair paste	Two part epoxy paste for patching repairs to concrete and bonding of precast concrete components, where strength, impermeability to water and resistance to aggressive chemicals is essential.	Potable Water approved - complies to AS/NZS4020.	To bond Expoband F to concrete substrates.
	<b>Renderoc G</b>	Geopolymer repair mortar	Geopolymer repair mortar and lining system for use in highly corrosive environments, with high chemical and acid resistance, up to 35MPa. Can be applied up to 80mm deep.	Potable Water approved - complies to AS/NZS4020.	Repairs in highly corrosive and soft water environments.
	<b>Renderoc CAC</b>	Calcium aluminate repair mortar	High performance calcium aluminate repair mortar with superior biogenic corrosion defense, >70MPa. Fully compatible with the moist environment found in sewers.	Biogenic corrosion resistant.	Old and new sewer and sewage structures.



For galvanic repairs, choose from our range of Vector®, Galvashield® or Galavnade® corrosion protection technologies that have been tested and proven for use with the Fosroc Renderoc range. Parchem is the licensed distributor of Vector Corrosion Technologies products in Australia, and, Concrete Plus is the licensed distributor in New Zealand.

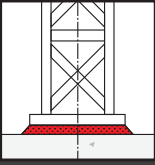

# Our Range

	Product	Type	Description	General Advantages	Typical applications
 <p><b>Grouts</b></p>	<b>Conbextra HF</b>	Highly fluid cementitious grout	Dual shrinkage compensated high flow cementitious precision grout for gap thicknesses up to 125mm. Strength up to 74MPa depending on consistency.	Excellent flow retention properties.	Grouting under large machine base plates.
	<b>Conbextra GP</b>	General purpose cementitious grout	General purpose shrinkage compensated (Class A) cementitious, flowable or trowellable grout for gap thicknesses from 10mm up to 100mm. Strength up to 75MPa depending on consistency.	Potable Water approved - complies to AS/ NZS4020.	General site grouting.
	<b>Conbextra UW</b>	Anti-wash out cementitious grout	Flowable under water cementitious grout which exhibits exceptional resistance to washing-out of the cement phase when placed in stationary or moving water.	Effectively displaces water.	Grouting or concrete reinstatement in submerged conditions.
	<b>Conbextra EP10</b>	Low viscosity epoxy grout	Low viscosity epoxy grout for situations where heavy dynamic or mobile loads are encountered. Can be used in conditions where chemical spills may occur. Ideal for grouting small gaps (<10mm) between a base plate and substrate. Can also be used to fill hairline cracks in concrete slabs.	Resistant to dynamic/ repetitive loads.	Grouting small gaps (<10mm) under baseplates and as a crack repair material
	<b>Conbextra EP65 Plus</b>	High strength epoxy grout	Ultra high strength (up to 125 MPa), two part epoxy grout for use in situations where heavy dynamic or mobile loads are encountered. Can be used in conditions where chemical spills may occur. Designed for heavy duty grouting of gaps between 10mm to 100mm.	Resistant to heavy dynamic loads. Potable Water approved – complies to AS/ NZS4020.	Grouting under baseplates and turbines.
	<b>Conbextra EP120</b>	Free flowing epoxy grout	Two part epoxy grout for gaps up to 120mm, in situations where heavy dynamic or mobile loads are encountered. Can be used in conditions where chemical spills may occur.	For large volume pours.	Grouting reciprocating machinery, high speed turbines, and centrifuges.
	<b>Conbextra EP300 DP</b>	Low exotherm epoxy grout	Three part epoxy grout for gaps up to 300mm, in situations where heavy dynamic or mobile loads are encountered. Particularly well suited to applications where long working time and/or large volume grouting is required.	Low exotherm.	Grouting reciprocating machinery, high speed turbines, and centrifuges.
	<b>Nitofill PU130</b>	Hydrophobic polyurethane grout	Multi-purpose hydrophobic polyurethane injection resin which is mixed with nominated levels of accelerator to initiate expansion in the product to seal leaking cracks and joints in concrete and fill voids in generally inaccessible locations.	Withstands high hydrostatic pressure.	Multi-purpose injection resin used to seal leaking cracks, failed joints, or fill voids and fractures in concrete structures.
	<b>Nitofill PU150</b>	Hydrophilic polyurethane grout	Multi-purpose hydrophilic polyurethane injection resin with high elongation and flexibility. Reacts with available water to initiate expansion in the product to seal leaking cracks and joints in concrete and fill voids in generally inaccessible locations.	Potable Water approved - complies to AS/ NZS4020.	Pump directly into leaking cracks, fractures or joints in concrete.



## FOR TOUGHER STRONGER CONCRETE



Developed by Eden Innovations LLC, EdenCrete® is a carbon nanotube-enriched liquid additive that elevates concrete structures to new levels of strength and toughness. When added to concrete mixtures, it performs like multiple additives rolled into one. It boosts surface abrasion resistance and produces extremely low permeability while improving strength properties [i.e., compressive, flexural, and split-tensile] like no other product on the market today. EdenCrete is ideal for use in new concrete for water and waste water projects.

Parchem is the licensed distributor of EdenCrete products in Australia, and, Concrete Plus is the licensed distributor in New Zealand.





# FUTURE PROOF

WITH FOSROC  
INDUSTRY  
SOLUTIONS



*constructive solutions*

## **World leaders in construction solutions**

Fosroc is a world leader in the delivery of virtually any type of construction project, combining high quality products, expert technical support, customer service and innovation.

**AU 1800 812 864** [fosroc.com.au](http://fosroc.com.au)

**NZ 0800 657 156** [fosroc.co.nz](http://fosroc.co.nz)

**Parchem Construction Supplies Pty Ltd** 1956 Dandenong Rd, Clayton VIC Australia 3168

**Concrete Plus Ltd** 150 Hutt Park Rd, Gracefield, Lower Hutt 5010, New Zealand

\* Fosroc, the Fosroc logo, Conbextra, Dekguard, Proofex, Supercast, Nitoseal, Nitoflor, Cemtop and Renderoc are trade marks of Fosroc International Limited, used under licence. Vandex is a registered trade mark and is used under licence. Edencrete and the Edencrete logo are registered trade marks of Edencrete LLC, used under licence. Corkjoint is a trade mark of Parchem Construction Supplies Pty Ltd.

Project images are representations of the types of projects these products can be used for.

07/23

