

As suppliers of building and civil engineering products Parchem Construction Supplies Pty Ltd do not offer a design service. Information in this drawing is a suggestion only and must not be used for construction except as a signed off drawing by the specifier or contractor

**C** This drawing is the copyright of Parchem Construction Supplies and must not be reproduced in any part without prior written permission

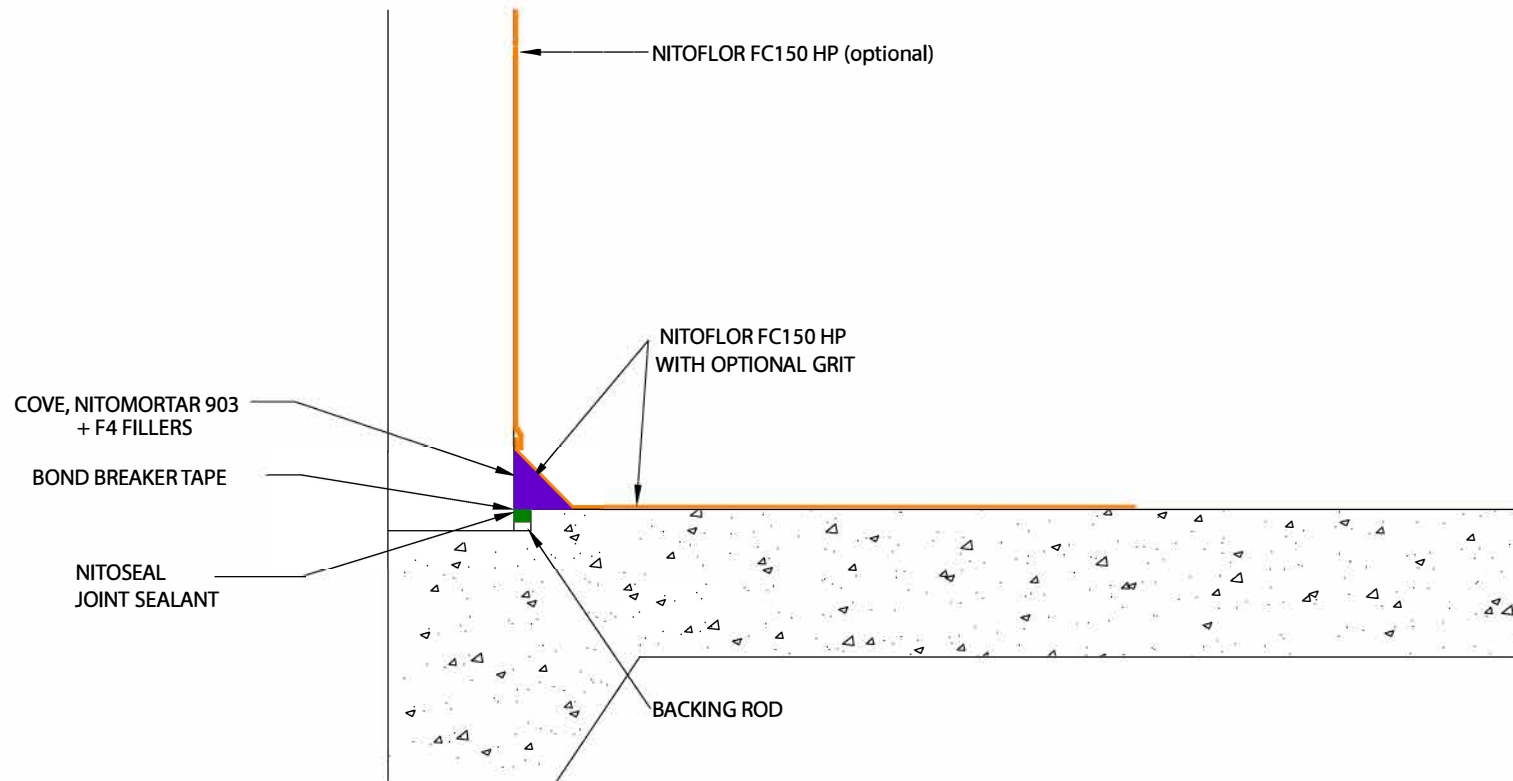

NOTE:  
REFER TO TECHNICAL DATA SHEET FOR ADVICE ON SURFACE PREPARATION  
NITOMORTAR 903 EPOXY ROLL COAT MAY BE REQUIRED FOR PRIMING

## TYPICAL FLOOR TO WALL COVE DETAIL - ROLL COAT EPOXY

SCALE:- NTS

DRAWN BY:- MN

DATE:- 16/6/13

LATEST AMENDMENT:- PJ

DATE:- 22/10/19

TSD/F-SD14

ISSUE NUMBER 3



PARCHEM CONSTRUCTION SUPPLIES  
1956 DANDENONG RD CLAYTON VIC 3168

[www.fosroc.com.au](http://www.fosroc.com.au)

1800 812 864

Fosroc and the Fosroc logo, are the trade marks of Fosroc International Limited, used under licence