

As suppliers of building and civil engineering products Parchem Construction Supplies Pty Ltd do not offer a design service. Information in this drawing is a suggestion only and must not be used for construction except as a signed off drawing by the specifier or contractor

This drawing is the copyright of Parchem Construction Supplies and must not be reproduced in any part without prior written permission

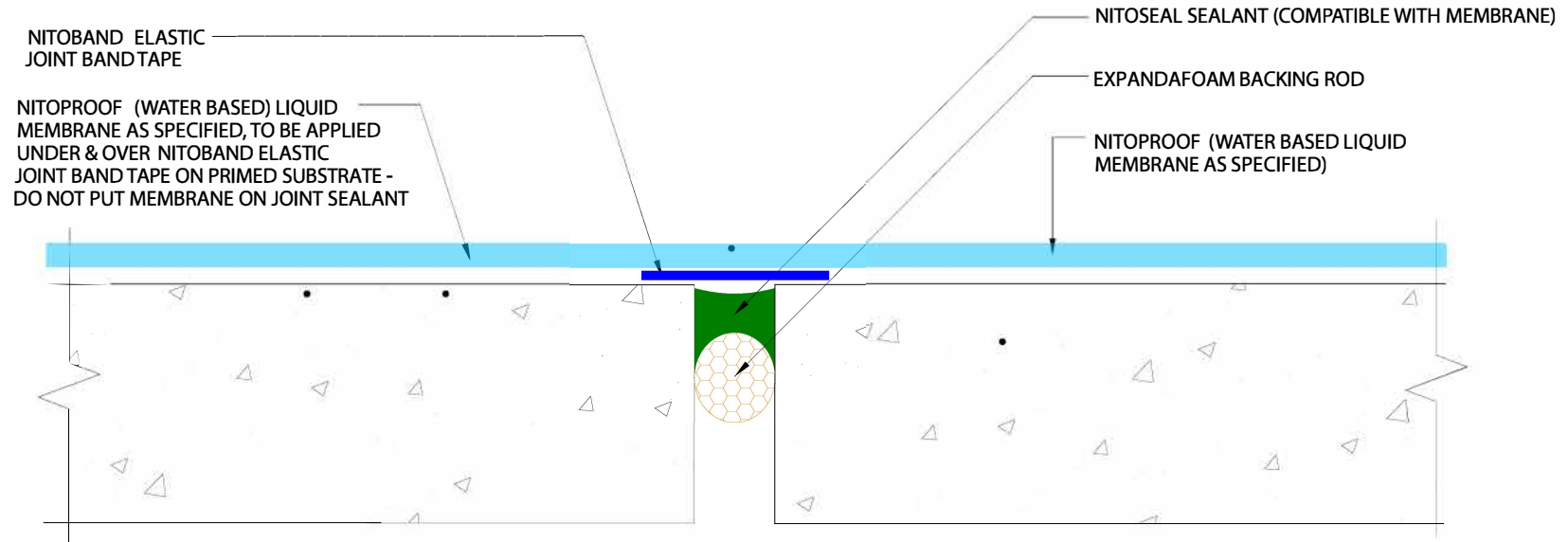

NOTE: FOR FALLS IN EXTERNAL AREAS ABOVE GROUND, SEE AS4654.2, CLAUSE 2.5.2. DO NOT USE DETAIL FOR EXPANSION JOINTS >25 MM WIDE

TYPICAL CONTINUOUS MOVEMENT JOINT & EXPANSION JOINT (25mm MAX WIDE) - LIQUID MEMBRANE

SCALE:- NTS

DRAWN BY:- MN  
DATE:- 11/6/14

LATEST AMENDMENT:- PJ  
DATE:- 30/10/19

TSD/W-WASD09

ISSUE NUMBER 2



PARCHEM CONSTRUCTION SUPPLIES  
7 LUCCA ROAD, WYONG  
NSW 2259

[www.fosroc.com.au](http://www.fosroc.com.au)

1800 812 864

Fosroc and the Fosroc logo, are the trade marks of Fosroc International Limited, used under licence