

As suppliers of building and civil engineering products Parchem Construction Supplies Pty Ltd do not offer a design service. Information in this drawing is a suggestion only and must not be used for construction except as a signed off drawing by the specifier or contractor

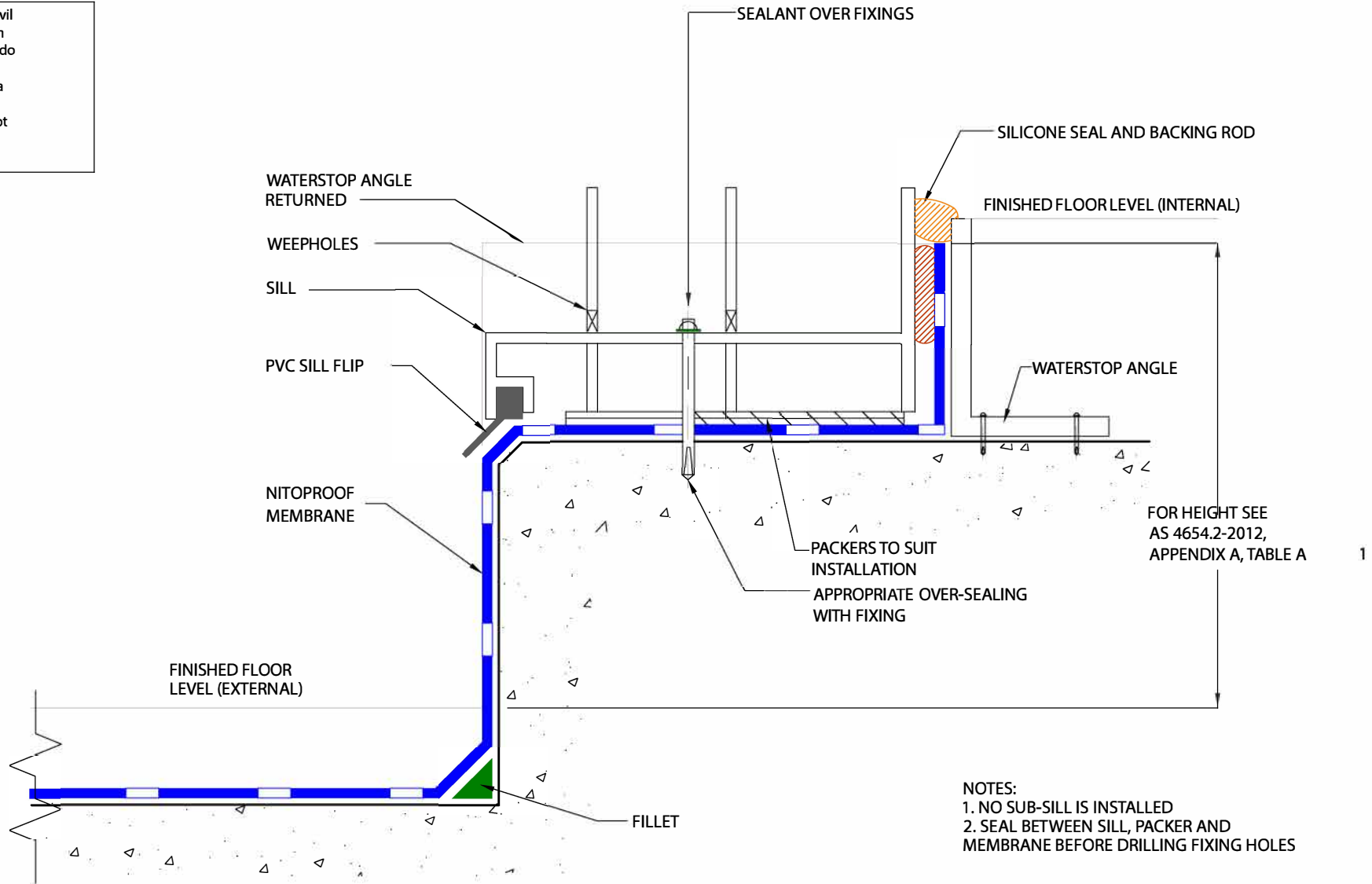

- NOTES:
 1. NO SUB-SILL IS INSTALLED
 2. SEAL BETWEEN SILL, PACKER AND MEMBRANE BEFORE DRILLING FIXING HOLES

NOTE: FOR FALLS, SEE AS 4654.2 - 2012, CLAUSE 2.5.2

NITOPROOF - MEMBRANE TERMINATION AT EXTERNAL OPENING DOORS (b) (ii) NO SUB-SILL

SCALE:- NTS
 DRAWN BY:- MN
 DATE:- 1/3/13
 LATEST AMENDMENT:- PJ
 DATE:- 23/10/19

TSD/W-ISD25 ISSUE NUMBER 2



PARCHEM CONSTRUCTION SUPPLIES
 7 LUCCA ROAD, WYONG
 NSW 2259
 www.fosroc.com.au
 1800 812 864
 Fosroc and the Fosroc logo, are the trade marks of Fosroc International Limited, used under licence