

As suppliers of building and civil engineering products Parchem Construction Supplies Pty Ltd do not offer a design service. Information in this drawing is a suggestion only and must not be used for construction except as a signed off drawing by the specifier or contractor

**C** This drawing is the copyright of Parchem Construction Supplies and must not be reproduced in any part without prior written permission

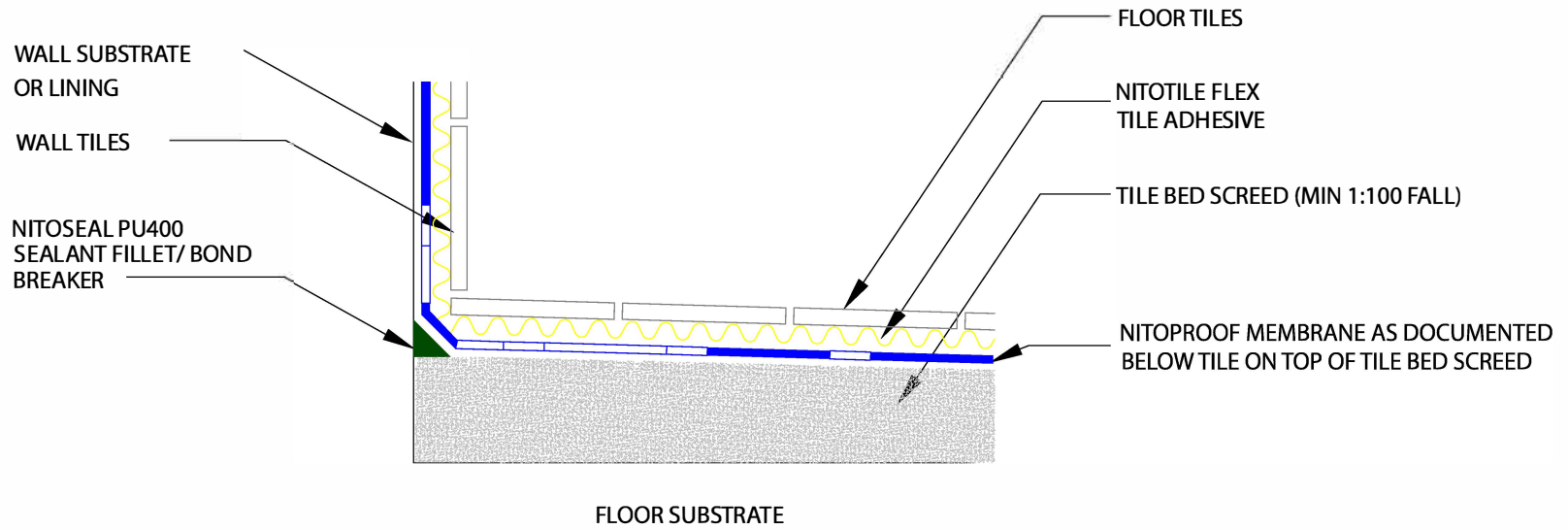

NOTE: WATERPROOF MEMBRANES SHOULD BE TERMINATED AT A MINIMUM HEIGHT OF 150mm ABOVE FINISHED FLOOR LEVEL (EXCEPT IN SHOWER AREAS)

**TYPICAL UNDER-TILE WATERPROOFING/TILE ADHESIVE SYSTEM  
(MEMBRANE OVER SCREED) - MEETS AS3740**

SCALE:- NTS

DRAWN BY:- MN  
DATE:- 16-7-13

LATEST AMENDMENT:- PJ  
DATE:- 30/10/19

**TSD/W-WASD08**

ISSUE NUMBER 2



PARCHEM CONSTRUCTION SUPPLIES  
7 LUCCA ROAD, WYONG  
NSW 2259  
[www.fosroc.com.au](http://www.fosroc.com.au)  
1800 812 864  
Fosroc and the Fosroc logo, are the trade marks of Fosroc International Limited, used under licence